

# STP-iXA2206 integrated turbomolecular pump

The STP-iXA2206 series magnetically levitated turbomolecular pump provides industry-leading performance and incorporates a small power supply into the onboard control unit – the latest technology of the well-established STP-iXA2205 series.

The height of the pump is equal to the STP-A2203C and is also equal to the height of the STP-iXA2205 series without its power supply (iPS-1200). This fully integrated product offers easy installation and a small footprint as an all-in-one solution for all application tools.



## Features and benefits

- Fully Integrated Onboard Controller
  - Eliminates connection cable between pump and control unit
  - Eliminates installation space and cost required by conventional racked type control unit
  - Second speed function is available
  - Dust and water protection (equivalent to IP54 specification) as standard
- Improved Maximum Throughput
  - Pumping speed performance of STP-A2203C is maintained and maximum throughput capability increased
- Compact Design
  - Height of STP-iXA2206 series is equal to existing STP-A2203C and a 25% reduction over STP-iXA2205CP
  - Size compatibility and elimination of the thick interconnecting cable enables easy retrofit from existing pump models
- Maintenance Function
  - Same maintenance call functions are available as the SCU-1400/1500/1600 controller models. Process Recorder Function (records certain pump parameters at designated interval) is newly added, which supports determination of the optimum maintenance interval timing
- Options
  - TMS unit is available for processes generating by-products
- Communication
  - I/O Remote, RS232C, RS485, STP-Link are standard ports
  - Profibus, DeviceNet and Lonworks can be selected as an option
- Compliant Standards
  - UL marked, CE marked, SEMI-S2 compliant with RoHS directive

# Technical data

Inlet flange size	ISO250F/VG250/ICF305	
Backing port size	KF40	
Pump speed N <sub>2</sub> /Ar	2200/1900	Litres/second
Compression ratio N <sub>2</sub> /H <sub>2</sub>	>10 <sup>8</sup> / 1 x 10 <sup>4</sup>	
Ultimate pressure	10 <sup>-7</sup> (10 <sup>-9</sup> )	Pa (Torr)
Allowable backing pressure	266 (2)	Pa (Torr)
Max gas flow N <sub>2</sub> <sup>*1</sup> (water cooled only)	3000 (5.07)	sccm (Pa m <sup>3</sup> /sec)
Max gas flow Ar <sup>*1</sup> (water cooled only)	1400 (2.36)	sccm (Pa m <sup>3</sup> /sec)
Rated speed	27000	rpm
Run-up time to 90% rated speed	<8	minutes
Mounting position	Any orientation	
Input voltage	200-240	V
Maximum input power (without TMS)	1200	VA
Weight	62	kg

## Pumping speed

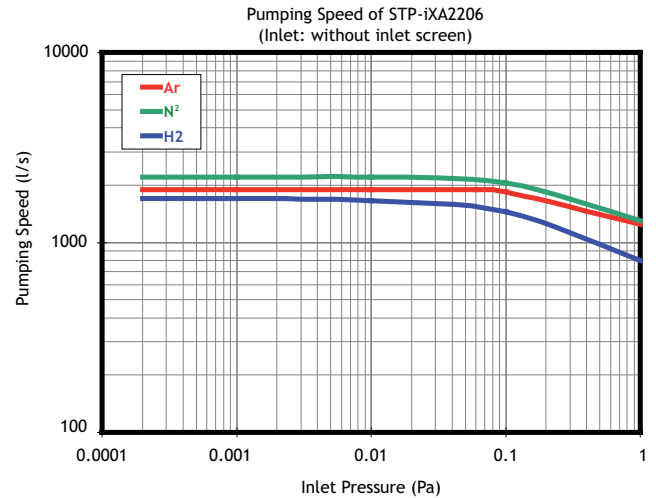

\*1: The maximum gas flow is applicable under conditions that N<sub>2</sub> or Ar gas is pumped continuously with water cooling temperature between 15-25° C and the backing pump (10,000 l/min size) is used. It is changed on condition.

## Dimensions - mm

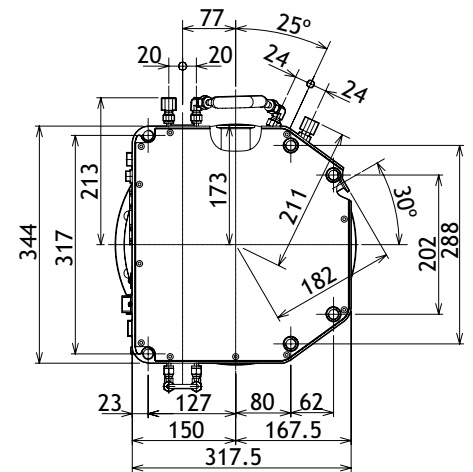
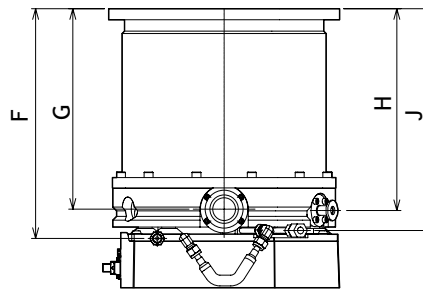
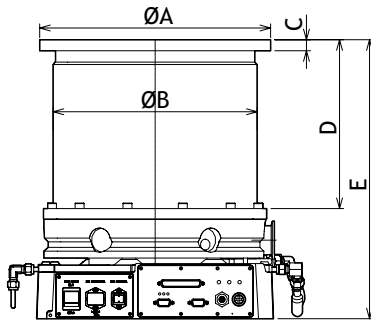

Inlet port flange	VG250	ISO250F	ICF305
ØA	350	335	305
ØB	296	296	296
C	18	16	28
D	235	245	275
E	395	405	435
F	312	322	352
G	281	291	321
H	283	293	323
J	322	332	322

## Global contacts

### EUROPE

UK Crawley +44 1293 528844  
 UK (local rate) 08459 212223  
 Belgium Brussels +32 2 300 0730  
 France Paris +33 1 4121 1256  
 Germany Munich 0800 000 1456  
 Italy Milan +39 02 48 4471

### USA

Niagara (toll free) +1 800 848 9800  
**BRAZIL**  
 Sao Paulo +55 11 3952 5000  
**ISRAEL**  
 Qiryat-Gat +972 8 681 0633

### ASIA PACIFIC

China (toll free) +86 400 111 9618  
 India, Pune +91 20 4075 2222  
 Japan, Yachiyo +81 47 458 8831  
 Korea, Bundang +82 31 716 7070  
 Singapore +65 6546 8408  
 Taiwan R.O.C. Jhunan Town +886 3758 1000



WWW.EDWARDSVACUUM.COM

info@edwardsvacuum.com

Publication Number: YT8100895, Issue B  
 © Edwards Limited 2013. All rights reserved.  
 Edwards and the Edwards logo are trade marks of Edwards Limited.