

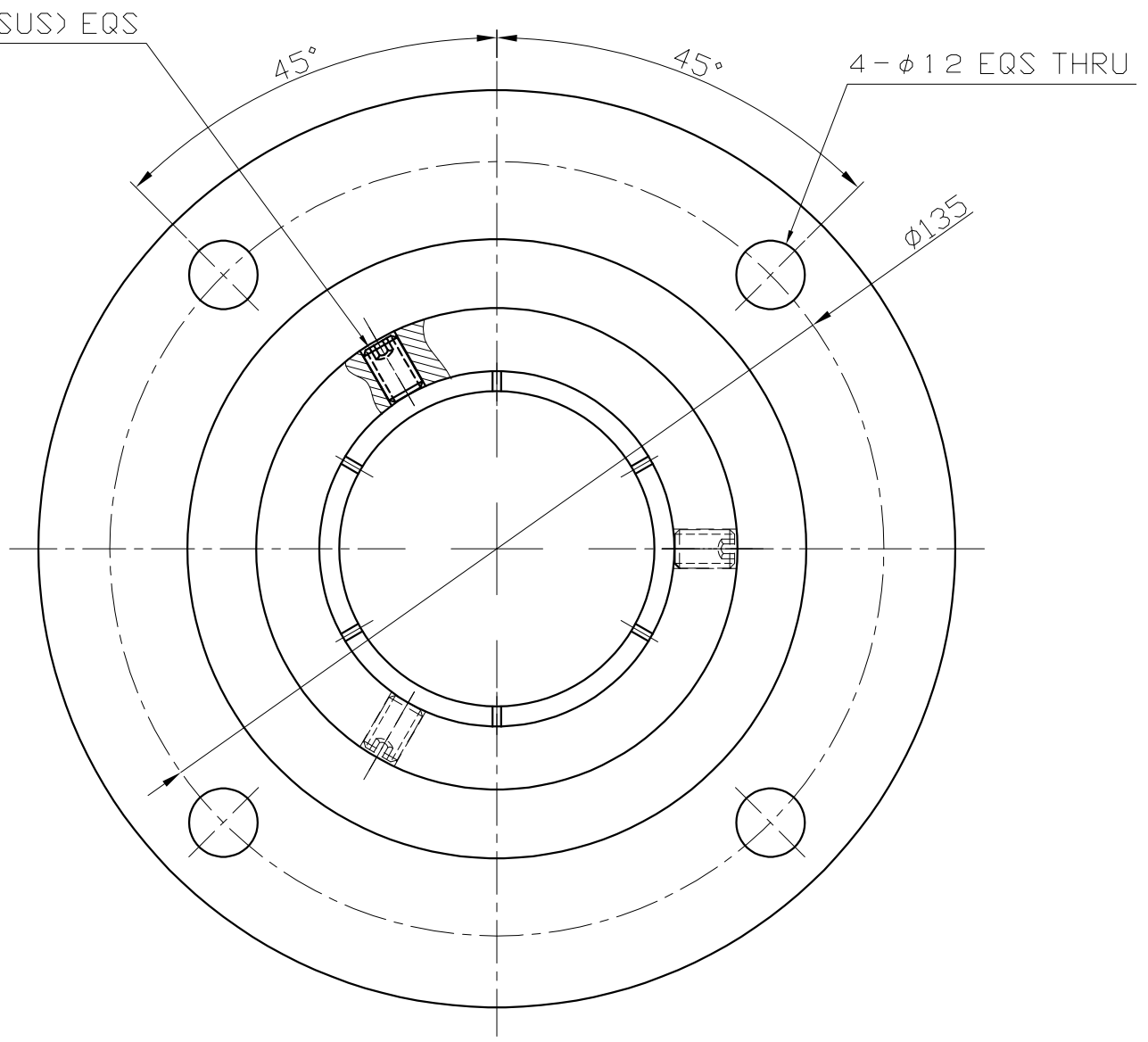

CUSTOMER MODEL:

PARTS	COUNT
o-ring G90 (FPM)	1
o-ring S50 (FPM)	2
screws M8 (SUS)	3

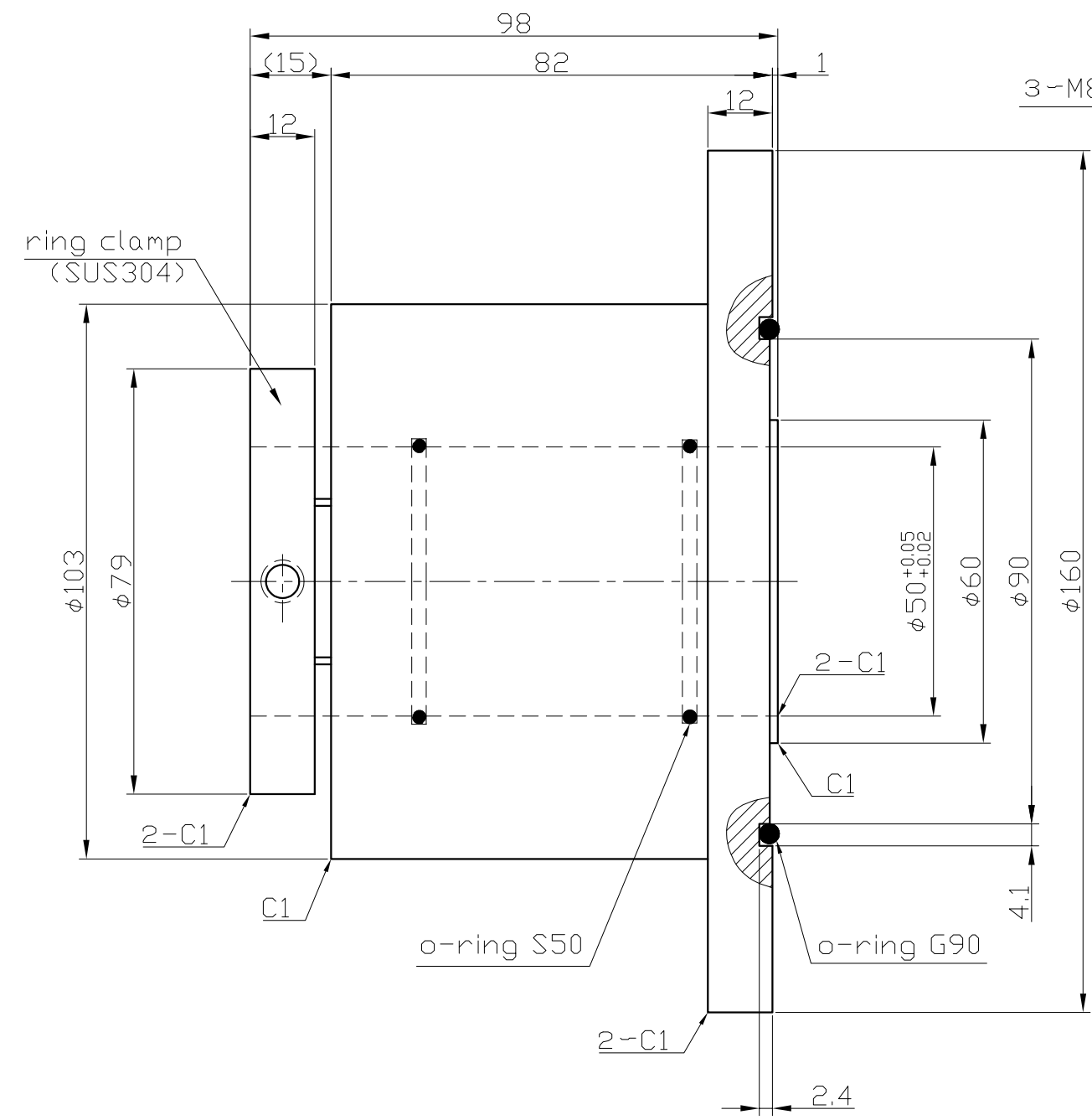

UNRELEASED
 PENDING CUSTOMER APPROVAL
 Approved _____ Date _____

- NOTES:
1. ROTARY SPEED: Max 60 RPM
 2. VAPOR PRESSURE: 1×10^{-6} Pa
 3. VACUUM LEAK CHECK TO LESS THAN 2×10^{-6} Pa.m³ /sec HELIUM
 4. TEMPERATURE: 0-80°C
 5. OPERATING ENVIRONMENT: NO WATER, OIL, OR DUST
 6. GASES SEALED: INERT GASES
 7. ROUGHNESS
 - SEAL SURFACE: $\sqrt{0.4}$
 - TOLERANCE REQUIRED: $\sqrt{0.4}$
 - OTHER: $\sqrt{0.4}$

TOLERANCES UNLESS STATED				NUB	DATE	CONTENT	NAME	PREPARED	CHECKED	DATE	MFC, ENG	DATE	MATERIAL	MODEL	P/N	SCALE	REV
PROCESSING	LATHE		PRESS														
SIZE	GENERAL	HOLE	GENERAL														
<6mm	±0.1	±0.15	±0.5														
6 - 30 mm	±0.2	±0.2	±0.7														
31 - 120 mm	±0.3	±0.2	±0.7														
121 - 315 mm	±0.5	±0.25	±1.0														
316 - 1000 mm	±0.8	±0.4	±1.5														
1001 - 2000 mm	±1.2	±0.6	±2.0														

PREPARED		MATL HOUSING SUS304
CHECKED	xiaolin	SHAFT SUS420
ENGINEER	2003-09-12	
DATE		
MFC, ENG		
DATE		

FEEDTHROUGH		Model
HFB050CN		
P/N	***	SCALE
		1/1
		REV
		A